

# SCHEDULE 1

## THE PATCH STAGE 4 BUILDING ENVELOPES

M.G.A. 2020 | ZONE 55

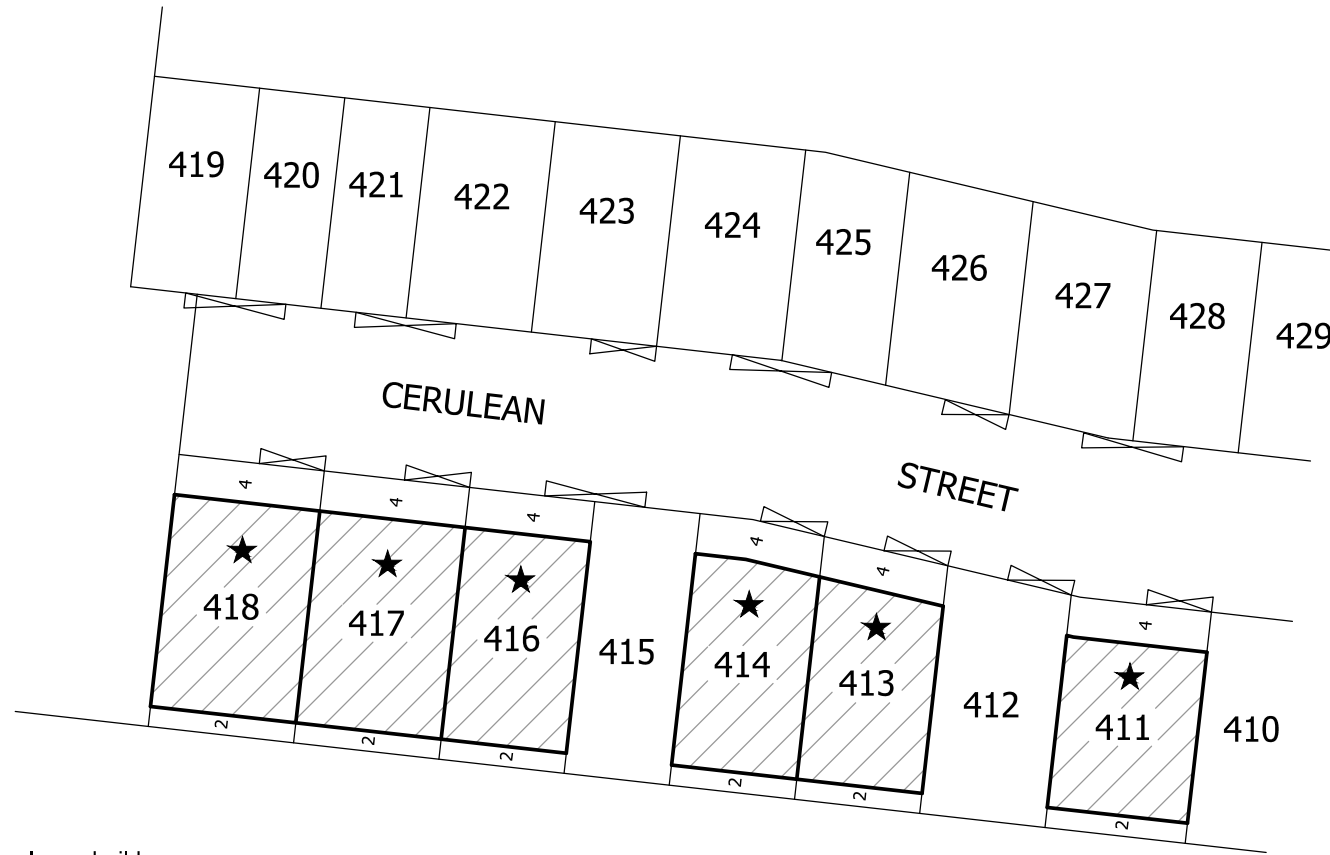

SEE SHEET 2

**NOTES:**

Side Setbacks

★ Unless nominated on this plan, a build to boundary zone only applies to one of the side of the lot where the crossover exists. A setback of at least 1 metre must be provided for the opposite side boundary.

⌘ Indicative cross over location

80171BE-017E.DWG



MC MULLEN NOLAN GROUP  
31/574 Plummer Street  
Port Melbourne VIC 3207  
Tel: (03) 7002 2200  
Fax: (08) 7002 2299  
Email: info@mngsurvey.com.au

SCALE  
1:750

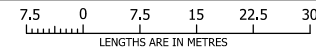

ORIGINAL SHEET  
SIZE A4

SHEET 1 OF 2

VERSION E



# SCHEDULE 1

## THE PATCH STAGE 4 BUILDING ENVELOPES

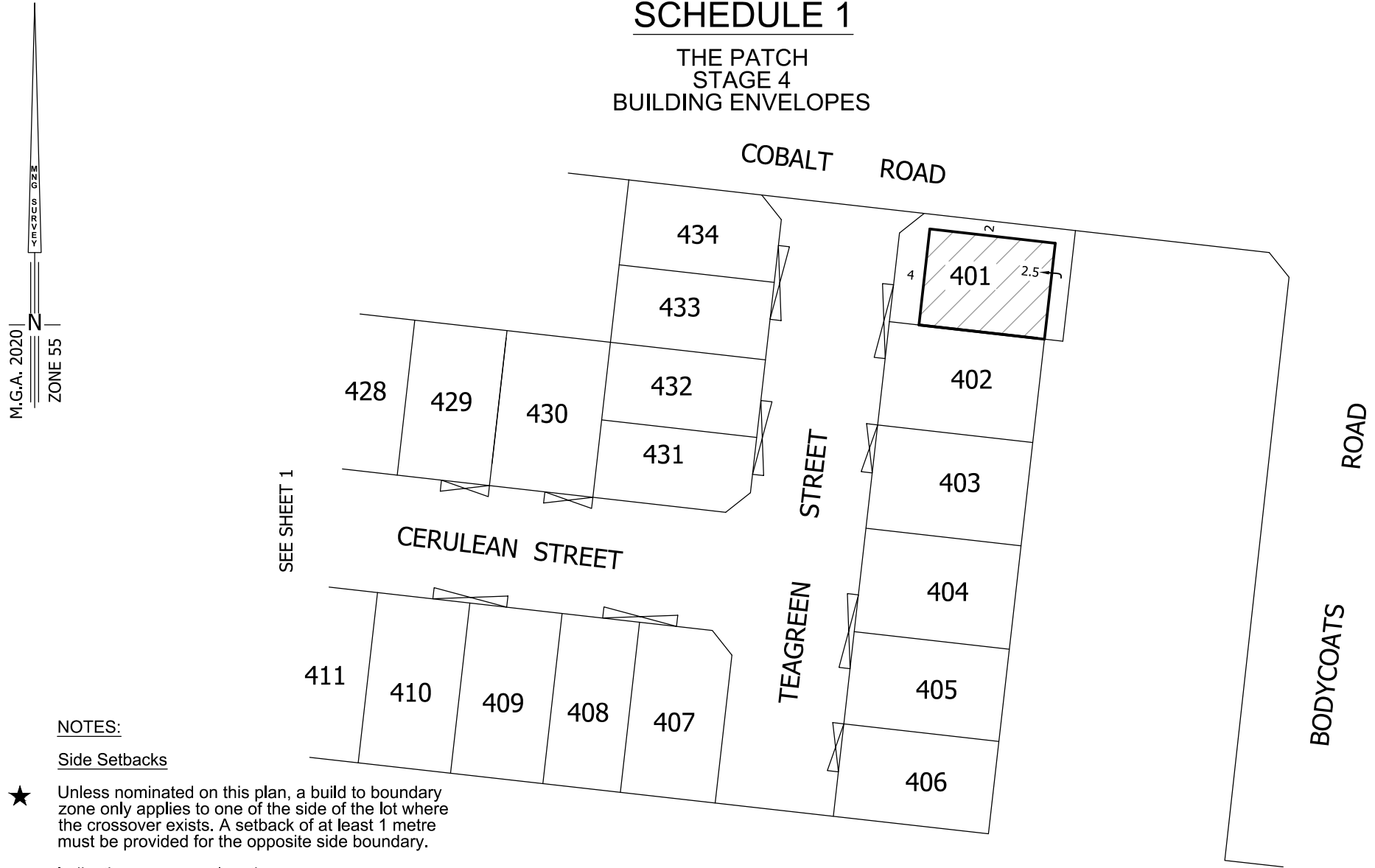

**NOTES:**

Side Setbacks

★ Unless nominated on this plan, a build to boundary zone only applies to one of the side of the lot where the crossover exists. A setback of at least 1 metre must be provided for the opposite side boundary.

⚡ Indicative cross over location

80171BE-017E.DWG



MC MULLEN NOLAN GROUP  
31/574 Plummer Street  
Port Melbourne VIC 3207  
Tel: (03) 7002 2200  
Fax: (08) 7002 2299  
Email: info@mngsurvey.com.au

SCALE  
1:750

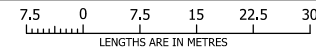

ORIGINAL SHEET  
SIZE A4

SHEET 2 OF 2

VERSION E

